





Offers over £1,250,000

46 Langstone Road

Havant, PO9 1RF

- FOUR DOUBLE BEDROOMS
- FOUR RECEPTION ROOMS
- ENSUITE AND DRESSING ROOM TO MASTER
- DOUBLE GARAGE
- GATED ACCESS
- ONE BEDROOM SELF CONTAINED ANNEXE
- PRIVATE COASTAL ACCESS
- ENSUITE TO SECOND BEDROOM
- UTILITY ROOM
- HIGH SPECIFICATION THROUGHOUT

A striking coastal residence extending to over 3,900 sq ft, The Drift House occupies a prime position backing onto the Hayling Billy Line with panoramic views across Langstone Harbour and the Solent. Built in 2011, this elegant four/five bedroom home is defined by its grand pillared entrance, sweeping staircase and beautifully proportioned living spaces, including multiple reception rooms and a bespoke kitchen designed for both family life and entertaining. Upstairs, four generous double bedrooms include a luxurious principal suite with private balcony and breathtaking waterside views, alongside dressing room and en-suite. A substantial loft room adds further versatility, ideal as a cinema or games space. Complementing the main house is a detached annexe with business consent, offering excellent potential for home working, guest accommodation or lifestyle use, alongside a double garage and extensive parking. Set within a south-westerly facing garden, the property also benefits from private gated access leading directly to the shoreline, making this a truly rare opportunity to acquire a landmark home in an exceptional waterfront setting.



We are delighted to present The Drift House, set in a commanding position backing onto the Hayling Billy Line and enjoying far-reaching views across Langstone Harbour, the Nature Reserve and towards the Solent.

Constructed in 2011, this striking home is introduced by a grand pillared entrance, setting the tone for the spacious and elegant accommodation within. Upon entering, you are welcomed into an impressive entrance hall, complete with a feature curved staircase rising to the upper floors, creating a real sense of arrival.

The ground floor offers superb flexibility for modern family living and entertaining, comprising a cloakroom, study, generous sitting room, and a further family room. A standout feature is the L-shaped dining room, which flows seamlessly into a bespoke fitted kitchen, thoughtfully designed with both style and practicality in mind. A separate utility room provides additional convenience.

To the first floor, the property continues to impress with four well-proportioned double bedrooms and a family bathroom. The principal suite is a true highlight, featuring bi-fold doors opening onto a private balcony, perfectly positioned to take in the breath taking coastal views. This luxurious space is further enhanced by a walk-in L-shaped dressing room and en-suite shower room. Bedroom two also benefits from its own en-suite, ideal for guests or family members seeking additional privacy.

From the first floor, a ladder-style staircase provides access to a substantial loft room, offering excellent additional space and suited to a variety of uses.

Externally, the property is equally impressive. Set well back from the road behind electric gates, a shingle driveway provides extensive parking alongside a detached double garage with electric charging point. A notable addition is the detached one bedroom annexe, recently refurbished as a sitting room/home office, cloakroom, kitchen/store area and bedroom/office—perfect for those working from home, additional income (stp), multi-generational living, or even conversion into a gym or studio.

The rear garden enjoys a south-westerly aspect, ideal for enjoying afternoon and evening sun, and is a true lifestyle feature of the home. Gated access at the rear leads to a private pathway, providing direct access down to the beach and waterfront, offering a rare opportunity to enjoy coastal living at its finest.

The Drift House represents a unique opportunity to acquire a substantial, beautifully designed home in an enviable waterside setting, combining space, flexibility, and truly stunning surroundings.







Floor Plans

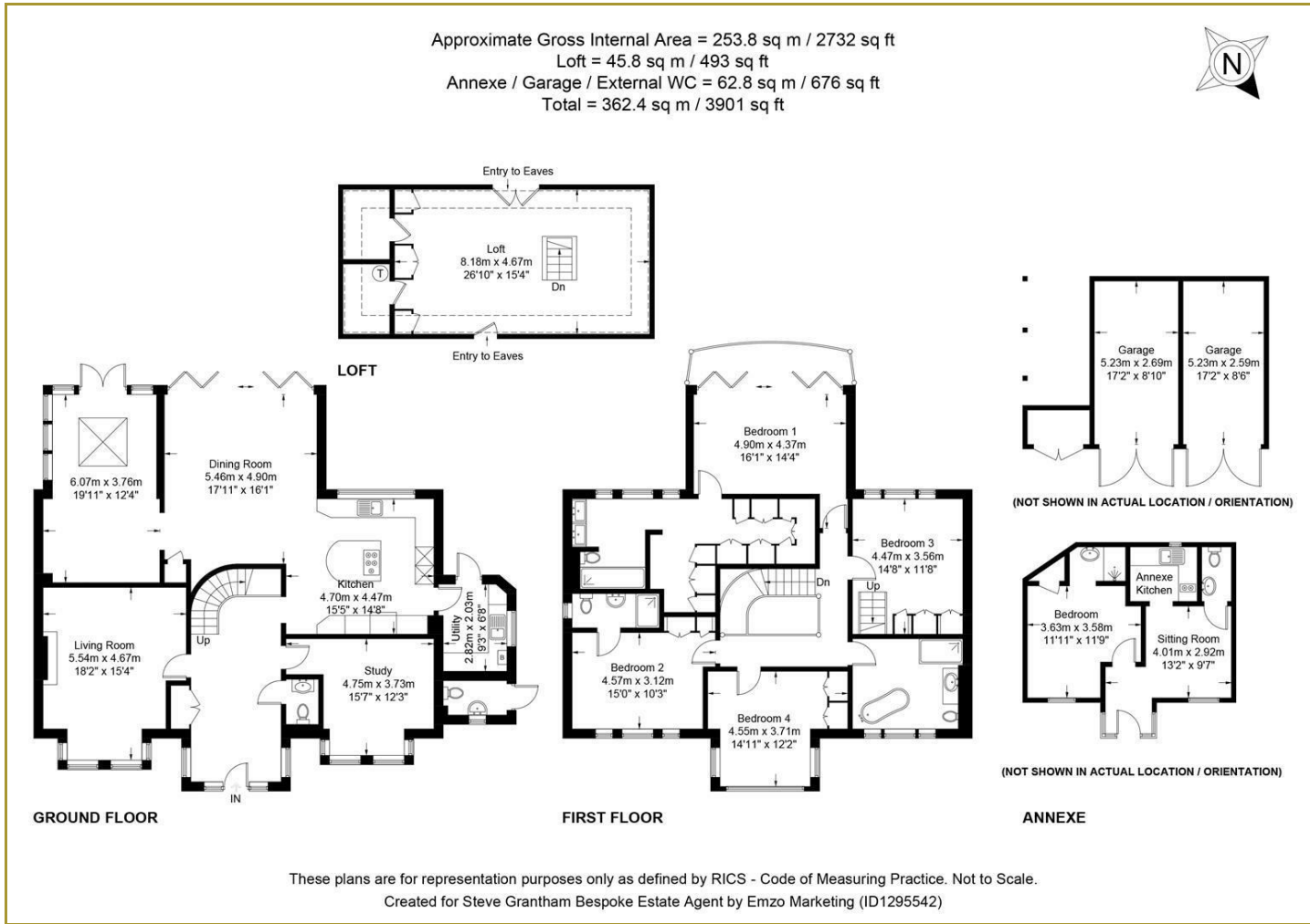

Location Map

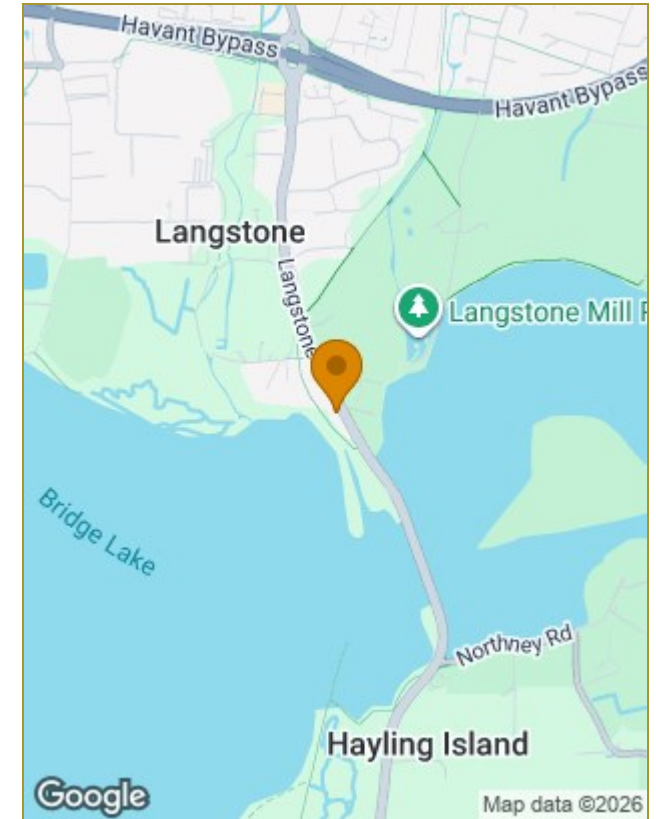

Energy Performance Graph

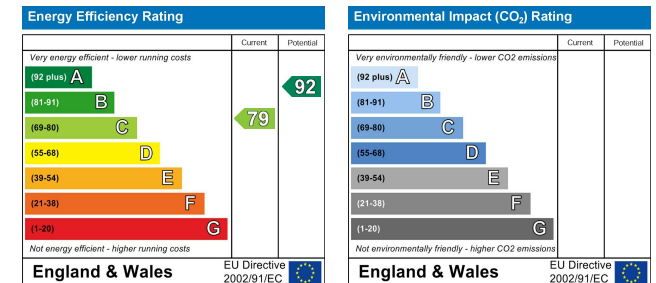

Should a purchaser(s) have an offer accepted on a property marketed by Steve Grantham Bespoke Estate Agent, they will need to undertake an identification check. This is done to meet our obligation under Anti Money Laundering Regulations (AML) and is a legal requirement. We use a specialist third party service to verify your identity. The cost of these checks is £30 inc. VAT per named purchaser, which is paid in advance, when an offer is agreed and prior to a sales memorandum being issued. This charge is non-refundable under any circumstances.

The particulars are set out as a general outline only for the guidance of intended purchasers or lessees, and do not constitute, any part of a contract. Nothing in these particulars shall be deemed to be a statement that the property is in good structural condition or otherwise nor that any of the services, appliances, equipment or facilities are in good working order. Purchasers should satisfy themselves of this prior to purchasing.